

**INSTALLATION INSTRUCTIONS FOR
DYNOMAX KIT: 19428**

2006 Dodge Ram 1500 All Engines, All Models
2WD/4 WD, Single Exhaust System



2701 N. Dettman Rd.
Jackson, MI 49201

DANGER WARNING: SHOULD THE PURCHASER DECIDE TO INSTALL ANY EXHAUST PRODUCT AT HOME, BE WARNED THAT PASSENGER CAR OR LIGHT DUTY TRUCK/VAN "BUMPER" JACKS ARE INTENDED FOR EMERGENCY USE ONLY. THE USE OF FRAME CONTACT JACK STANDS IN CONJUNCTION WITH A FLOOR JACK AS MAIN SUPPORT IS HIGHLY RECOMMENDED TO MINIMIZE ACCIDENTAL DROPPING OF A VEHICLE DURING THE INSTALLATION PROCESS.

NOTE: Read all instructions before starting any work.

1. Remove the original exhaust system from the vehicle. Lubricate the rubber isolators with WD-40, or a similar lubricant, to aid in removal of the metal rod hangers.
2. Install DynoMax inlet pipe **56080**. Use the following cut off information depending on the type of cab model. If installing this system on a quad cab, long bed truck (160.5" WB) no cut-off is required. If installing on a quad cab, short bed or reg. cab, long bed (140.5" WB) cut 20" off the outlet end of 56080. In installing on a reg. cab, short bed (120.5" WB) cut 40" off the outlet end of 56080.
3. Install DynoMax Ultra Flo Welded muffler **17235** with the center connection as the inlet. The muffler should be installed at approximately a 45° angle with the top tilting toward the driveshaft and the muffler side connection at the top (see system diagram). Also install clamp-on hanger **36318** at the muffler to inlet pipe connection. Insert the rod hanger into the rubber isolator hanging from the RH frame. Finger tighten the clamp connection.

4. Install DynoMax tail pipe **55284**. Insert the metal rod hangers into the rubber isolators on the crossmember and frame. Finger tighten the 3" inlet clamp.
5. Install spout **36388** onto the outlet end of tail pipe. Use the **33272** band clamp to connect the tip to the tail pipe. Install the band clamp with the fasteners on top.
6. Beginning at the inlet end, align the system and fully tighten all the clamps.
7. Please see system diagram on back page of these instructions.

KIT CONTAINS:

- (1) 17235 MUFFLER
- (1) 56080 INLET PIPE
- (1) 55284 TAIL PIPE
- (1) 36388 SS SPOUT
- (1) 36318 HANGER
- (2) 3" U-BOLT CLAMPS
- (1) 33272 3" BAND CLAMP
- (1) 702136 INSTRUCTION SHEET

19428 SYSTEM DIAGRAM

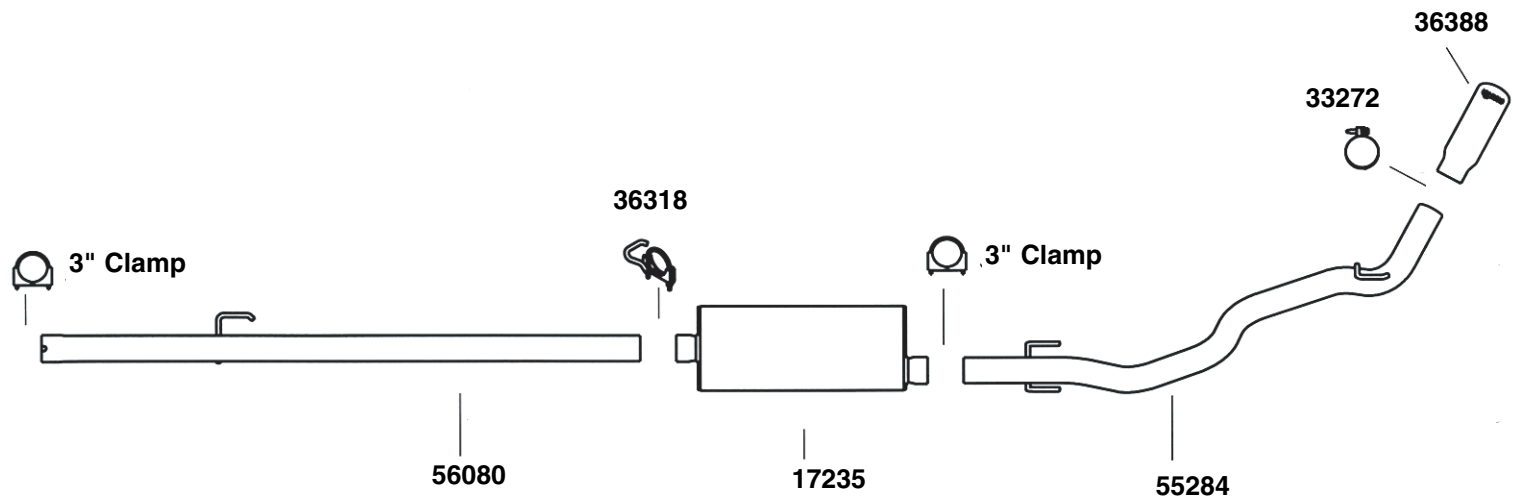

VIEW FROM TOP

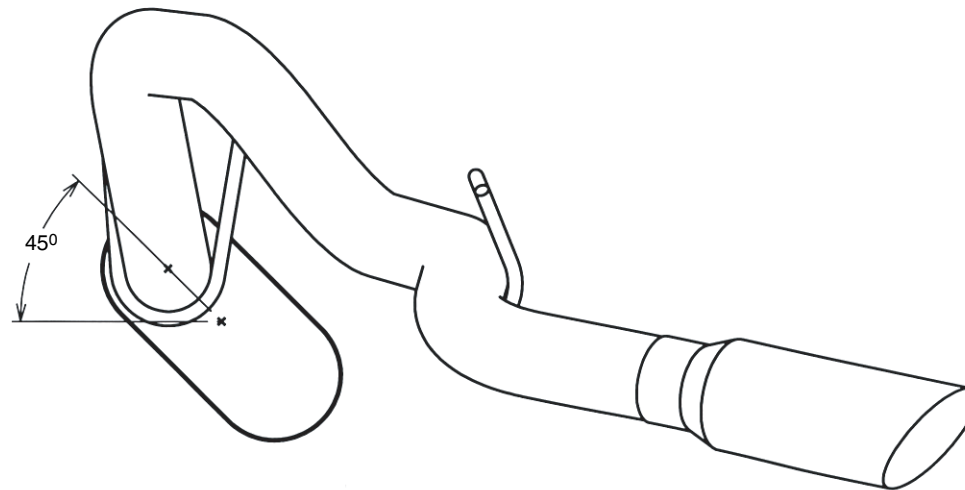

VIEW FROM REAR